

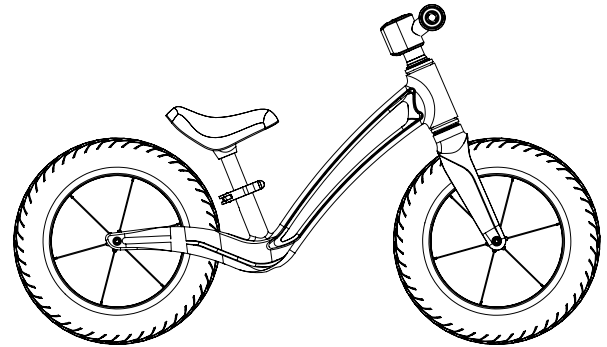

Balance Bike



---

## Attention!

SAFETY INFORMATION, INSTALLATION, CARE AND MAINTENANCE INSTRUCTIONS.  
READ PRIOR TO ASSEMBLING AND USING THE PRODUCT.

Vuly cares about safety. Adult supervision is required at all times whilst equipment is in use.

---

See [vulyplay.com/terms](https://www.vulyplay.com/terms) for the most recent Vuly warranty policies, terms and conditions.

Visit [www.vulyplay.com/install](https://www.vulyplay.com/install)  
for step by step video instructions,  
or scan this QR code:



### ATTENTION!

Safety information, installation and use instructions.  
Read prior to installing and using the monkey bar system.

See [VulyPlay.com/support](http://VulyPlay.com/support) for any updates to these instructions.

### WARNING!

- Adult assembly required.
- Adult supervision required at all times.
- Ensure that the system is secured with anchors or bolts before use.

### YOU WILL NEED FOR ASSEMBLY!

- 5mm Allen Key

## Vuly Play

95 Ingleston Rd, Brisbane QLD 4154

AU: 1300 667 514

US: 1-800-467-1421

[www.vulyplay.com](http://www.vulyplay.com)

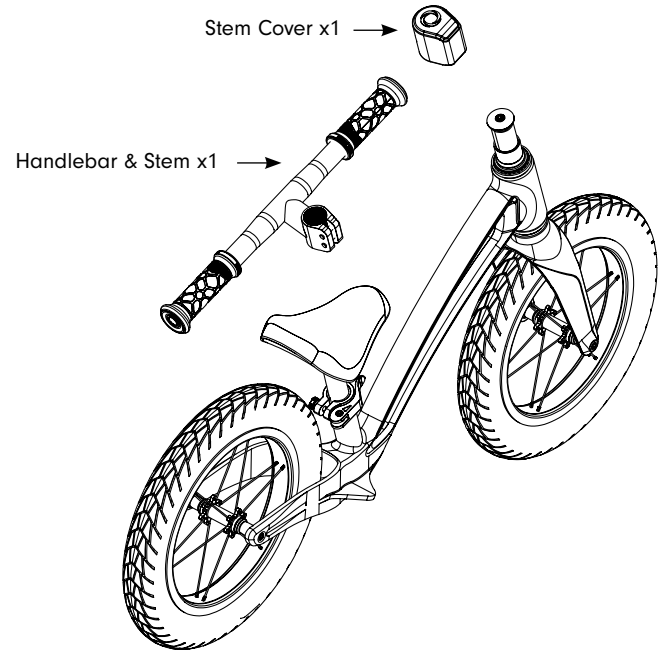

## Installing Handlebars

### Step 1:

Slide stem cover over stem. (fig. A.)

### Step 2:

2. Push stem cover further up stem until bolts are accessible (fig. B.)

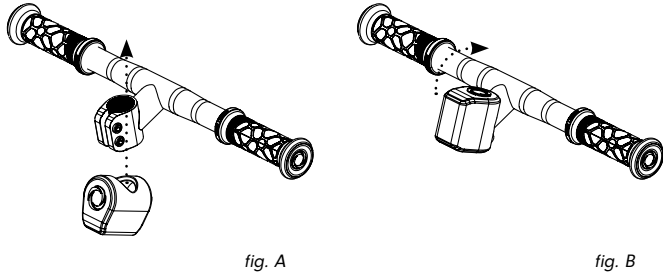

### Step 3:

Remove headset bolt and top cap from fork and place to the side. (fig. C)

### Step 4:

Assemble as illustrated. Ensure bearings and spacers are seated correctly and tighten headset bolt until bearings are compressed and rotate smoothly. (fig. D)

## Installing Handlebars

### Step 5:

Align handlebars to be inline with front wheel and fork. Tighten stem bolts. The stem should be tight enough to not move when twisted.

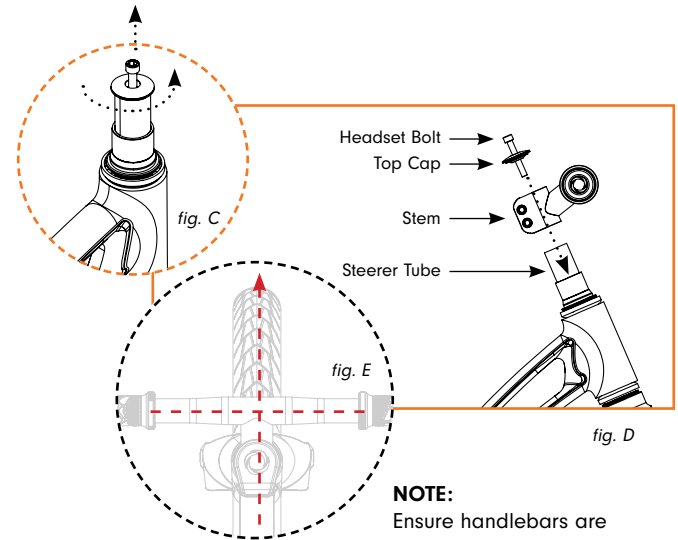

### NOTE:

Ensure handlebars are perpendicular to front wheel before tightening stem bolts (fig. E).

## Adjusting Seat Height

### Step 1:

Open quick release clamp lever. (fig. F)

### Step 2:

Adjust the seat height and ensure the seat is aligned to the frame. (fig. G)

**NOTE:** Proper seat height should allow the child to sit on the bike with both feet flat on the ground with a slight bend in their knees.

### Step 3:

Close quick release clamp lever. (fig. H)

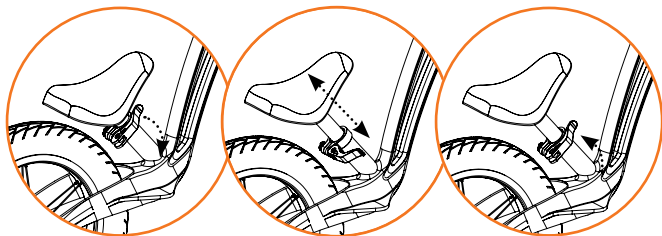

fig. F

fig. G

fig. H

## Quick Clamp Operation

### ATTENTION!

- Your Vuly Balance Bike is equipped with one quick release clamp to facilitate the adjustment of the seat height. Failure to properly install this quick release clamp on your bicycle may cause the seat to become detached from the bicycle while riding and result in serious bodily injury.
- A quick release clamp is a mechanism that uses a lever to tighten or loosen the clamp.
- When swinging the quick release clamp from open to closed, the clamp should grip firmly. This will fix the seatpost in place.

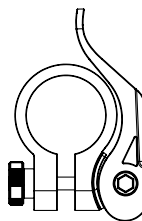

fig. I Closed

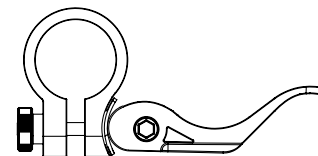
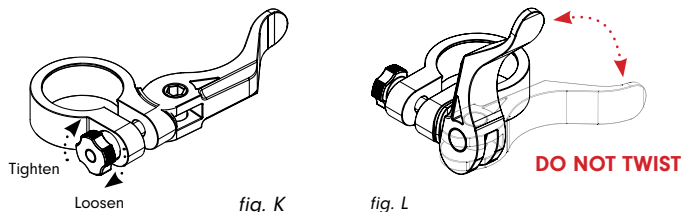

fig. J Open

### CAUTION!

• Be sure to operate the quick release clamp lever by hand only. Never use any other tool such as a hammer to tighten the quick release clamp lever, as this could cause damage to the lever and/or clamp.



• Make sure the quick release clamp levers are pushed fully to the closed position. Note: If the lever can be **easily** pushed to the closed position, this means the clamping strength is insufficient. Return the clamp lever to the open position and rotate the adjuster nut 1/8 of a turn clockwise. Push (do not twist or turn) to the closed position. The clamp should be tight enough to keep height position and not allow the seat to be moved with force of hands.

- CHOKING HAZARD - Un-assembled bikes and packaging contains small parts. Keep away from small children.
- Like other bicycles, using the Vuly balance bike can be dangerous and may result in injury or death even when used with proper safety precautions. Use common sense and at your own risk.
- Properly dispose of all plastic wrapping and packaging materials.
- This partially assembled bike requires full assembly by an adult according to this manual.
- Adult supervision is required at all times.
- Do not adjust the seat post above minimum insertion line as marked.
- Height range for usage is from 60cm - 120cm. Maximum load should not exceed 34kg. Approved for children 3 and above.
- Never ride near steps, public roads, vehicular traffic, water, swimming pools, sloped driveways, at night, or on rough and uneven surfaces. For use on smooth surfaces away from safety hazards only.
- This balance bike has no brakes. Riders must stop with their feet.
- The rider should not ride faster than he or she can stop safely and controllably.
- The seat should be adjusted properly so that the rider can touch the ground at all times.
- Always wear a helmet when riding. Failure to wear a properly adjusted and fitted helmet when riding can result in serious injury or death.
- Please retain this document for future reference.

Looking for the next bike for your child?

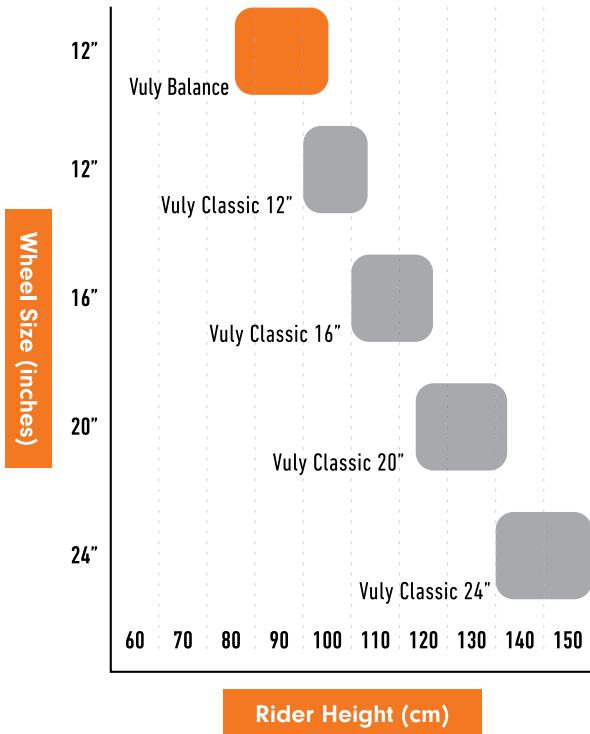

Take it to the streets  
with the new  
**VULY BIKES**

